

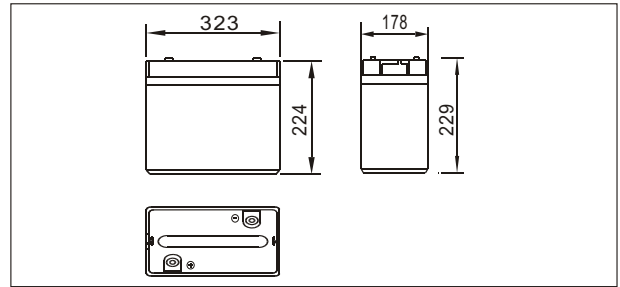

SW62000E(6V200AH)



● Outer dimensions (mm)



● Specifications

Nominal Voltage		6V
Rated capacity (10hour rate)		200 Ah
Dimensions	Total Height	229 mm (9.02 inches)
	Height	224 mm (8.82 inches)
	Length	323 mm (12.7 inches)
	Width	178 mm (7.00 inches)
Weight Approx		32 Kg (70.4 lbs)

● Terminal Type (mm)

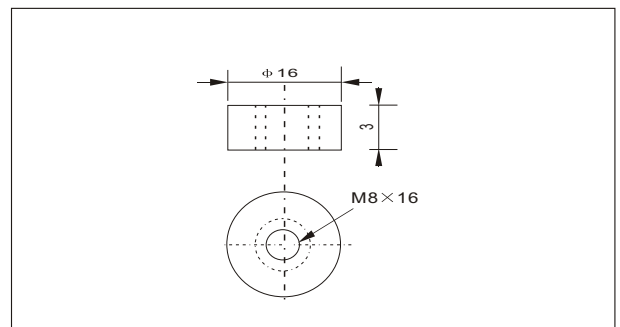

● Characteristics

Capacity 25°C(77°F)	10 hour rate(20A) 5 hour rate(32A) 1 hour rate(110 A)	200 AH 160 AH 110 AH
Internal Resistance	1.5 hour discharge to 5.25V	80 A
	Full charged Battery at 25°C(77°F)	2.2m Ω
Capacity affected by Temperature (10hour rate)	40°C(104°F)	102%
	25°C(77°F)	100%
	0°C(32°F)	85%
	-15°C(5°F)	65%
Self-Discharge at 25°C(77°F)	Capacity after 3 month storage	91%
	Capacity after 6 month storage	82%
	Capacity after 12 month storage	64%
Terminal	T19	
Charge (constant Voltage)	Cycle	Initial Charging Current less than 50 A Voltage 7.05-7.20V
	Float	Voltage 6.75-6.90V

● Discharge Curves 25°C(77°F)

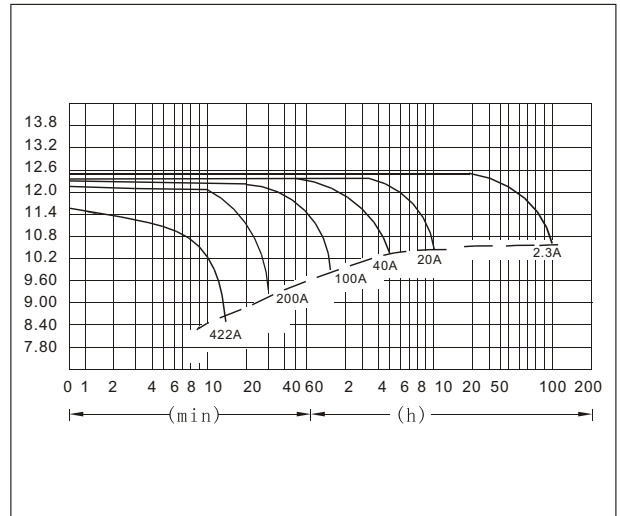

Constant Current(Amp) and Constant Power(Watt) Discharge Table at 25°C(77°F)

Time		10min	30min	1h	3h	4h	5h	8h	10h	20h	50h	100h
4.80V	A	422	228	120	51.4	40.0	33.0	23.3	21.0	11.34	4.72	2.42
	W	4686	2443	1390	595	463	382	269	243	131.3	56.2	28.8
5.10V	A	410	222	112.8	50.0	39.0	32.4	22.8	20.5	11.06	4.56	2.36
	W	4507	2420	1306	579	452	375	264	237	128.1	54.2	28.0
5.25V	A	392	211	109	48.8	38.4	32.0	22.6	20.0	10.92	4.48	2.30
	W	4368	2284	1265	565	445	371	262	234	126.5	53.4	27.4
5.40V	A	366	204	106	47.6	37.8	31.2	22.0	19.5	10.80	4.40	2.28
	W	4198	2198	1209	554	435	363	256	233	125.7	52.4	27.2
5.55V	A	336	188	99	46.0	36.7	30.4	21.4	19.00	10.26	4.32	2.20
	W	4126	2180	1177	547	433	362	255	226	122.1	51.4	26.2